



## 3-Way Diversion Stainless Steel Ball Valves

Female NPT Thread, 800 CWP (psig), Cold Non-Shock

### FEATURES

- Reinforced seats
- Meets NACE MR0175 (2000) & MR0103 (2012)
- Blow-out-proof stem design
- Adjustable packing gland
- Investment cast body

This product has been evaluated by an ANSI approved 3<sup>rd</sup> party testing agency and meet the requirements of the following NSF standards as noted below:

**NSF/ANSI 61 Section 8** "Drinking Water System Components - Mechanical Devices

(Low Lead and chemical / organics leaching test)

**NSF/ANSI 61 Annex G** "Lead Content Evaluation Procedure"

(Lead Free 0.25% max + chemical / organics requirements of ANSI/NSF 61 Section 8)

**NSF/ANSI 372** "Drinking Water System Components - Lead Content"

(Lead Free 0.25% max testing only)

### STANDARD MATERIAL LIST

	PART	MATERIAL
1	Lever and grip	304 SS w/vinyl
2	Stem packing	MPTFE
3	Stem bearing	RPTFE
4	Ball	A276-316
5	Seat (2)	RPTFE
6	Retainer	A276-316 (1/4" to 1") A351-CF8M (1.5" to 2")
7	Gland nut	A276-316
8	Stem	A276-316
9	Lever nut	18-8 SS
10	Body seal (1.5" to 2")	PTFE
11	Body	A351-CF8M

OPTION	SIZES
Standard Configuration	All
BSPP (Parallel) Thread Connection	1/4" to 2"
BSPT (Tapered) Thread Connection	1/4" to 2"
Stem Grounded	1/4" to 2"
2.25" CS Stem Extension	1/4" to 2"
UHMWPE Seats (Non-PTFE)	1/4" to 2"
Graphite Packing	1/4" to 2"
SS Latch-Lock Lever & Nut	1/4" to 2"
PTFE Trim	1/4" to 2"
Assembled Dry	1/4" to 2"
2.25" CS Locking Stem Extension	1/4" to 2"
Multifill Seats & Packing	1/4" to 2"
Oxygen Cleaned	1/4" to 2"
Grounded Ball & Stem	1/4" to 2"

### FLOW PATTERN

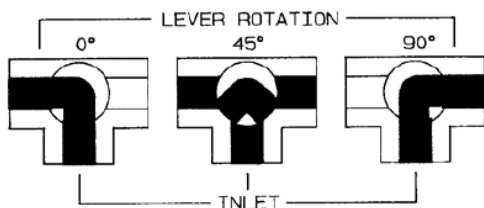

*NOTE: Open port pressure must exceed Closed port pressure.*



PART NUMBERS, WEIGHTS AND DIMENSIONS

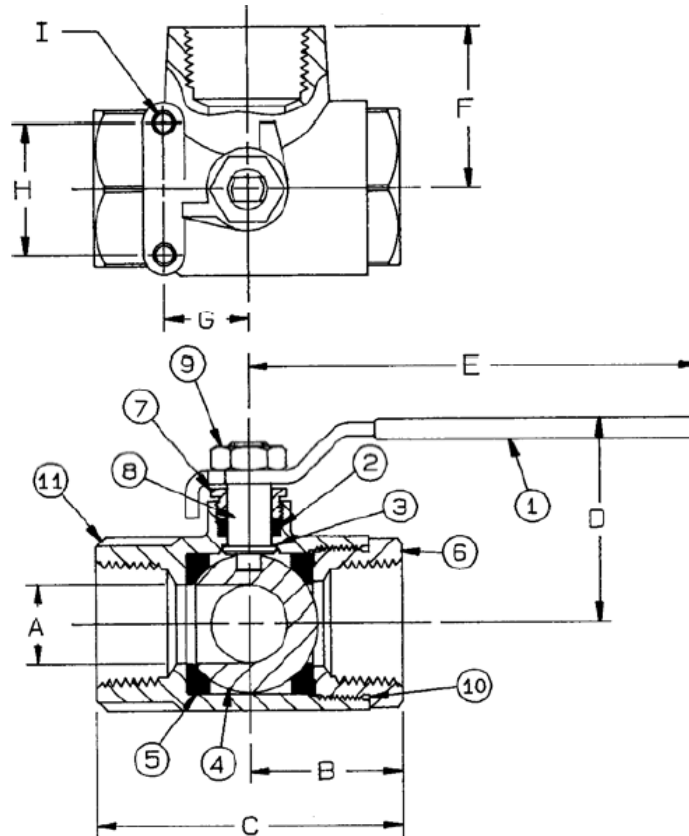

Part #	Size	A	B	C	D	E	F	G	H	I	WT
3-050-5.4-SSV	1/2"	0.505	1.12	2.32	1.80	3.88	1.18	0.875	1.375	10-24	0.75
3-075-012-SSV	3/4"	0.687	1.47	2.97	2.06	4.78	1.50	0.875	1.375	10-24	1.45
3-100-014-SSV	1"	0.875	1.60	3.20	2.15	4.78	1.68	0.875	1.375	10-24	1.86
3-150-034-SSV	1-1/2"	1.265	1.99	4.38	3.03	5.43	2.40	0.937	1.500	1/4-20	4.67
3-200-047-SSV	2"	1.515	2.75	5.45	3.22	5.43	2.81	0.937	1.500	1/4-20	7.02



### 800# SS (GRAPH 21)

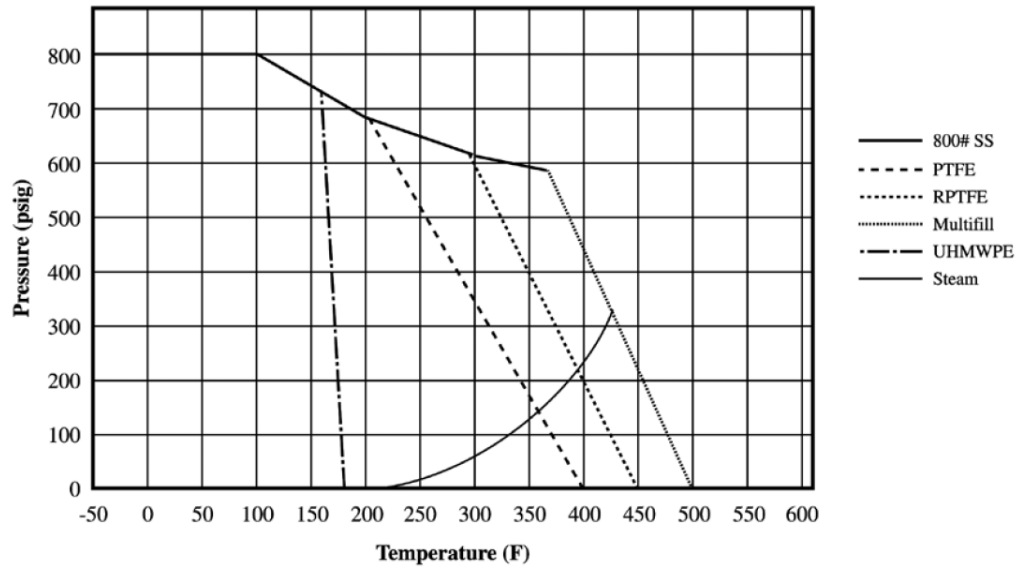

### 800# Nickel (GRAPH 22)

